

測量確認形地出画

目録生弥宮鏡

求積表

地番	41			
NO	X _n	Y _n	Y _{n+1} -Y _{n-1}	X _n · (Y _{n+1} -Y _{n-1})
5-62	84066.827	-7396.824	-20.544	-1727068.893888
5118	84067.504	-7396.538	20.949	1761130.141296
5117	84066.595	-7375.875	20.544	1727064.127680
5-61	84065.911	-7375.994	-20.949	-1761096.769539
合計				28.605549
合計面積				14.3027745
地積				14.30 m ²

地番	42			
NO	X _n	Y _n	Y _{n+1} -Y _{n-1}	X _n · (Y _{n+1} -Y _{n-1})
5117	84066.595	-7375.875	-21.526	-1809617.523970
5118	84067.504	-7396.538	-20.254	-1702703.226016
5-63	84068.473	-7396.129	1.129	94913.306017
5-64	84070.351	-7395.409	1.386	116521.506486
5-65	84072.260	-7394.743	0.720	60532.027200
5120	84072.435	-7394.689	19.731	1658833.214985
5119	84071.569	-7375.012	18.814	1581722.499166
合計				201.803868
合計面積				100.9019340
地積				100.90 m ²

地番	43			
NO	X _n	Y _n	Y _{n+1} -Y _{n-1}	X _n · (Y _{n+1} -Y _{n-1})
5119	84071.569	-7375.012	-19.684	-1654864.764196
5120	84072.435	-7394.689	-19.134	-1608641.971290
5-66	84074.176	-7394.146	1.079	90716.035904
5-67	84076.118	-7393.610	0.763	64150.078034
5122	84077.056	-7393.383	19.404	1631431.194624
5121	84076.211	-7374.206	18.378	1545152.605758
5107	84071.605	-7375.005	-0.806	-67761.713630
合計				181.465204
合計面積				90.7326020
地積				90.73 m ²

地番	44			
NO	X _n	Y _n	Y _{n+1} -Y _{n-1}	X _n · (Y _{n+1} -Y _{n-1})
5121	84076.211	-7374.206	-19.411	-1632003.331721
5122	84077.056	-7393.383	-18.928	-1591410.515968
5-68	84078.079	-7393.134	0.573	48176.739267
5-69	84079.557	-7392.810	0.348	29259.685836
5310	84079.691	-7392.785	18.838	1583893.219058
5109	84077.559	-7373.972	18.580	1562161.046220
合計				76.842692
合計面積				38.4213460
地積				38.42 m ²

総合計面積	244.3586565 m ²
-------	----------------------------

地番	地積
41	14.30 m ²
42	100.90 m ²
43	90.73 m ²
44	38.42 m ²

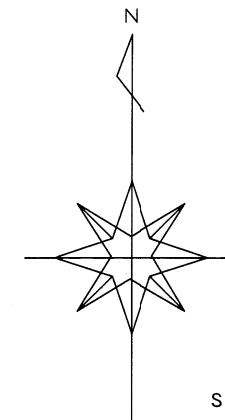

S=1:250

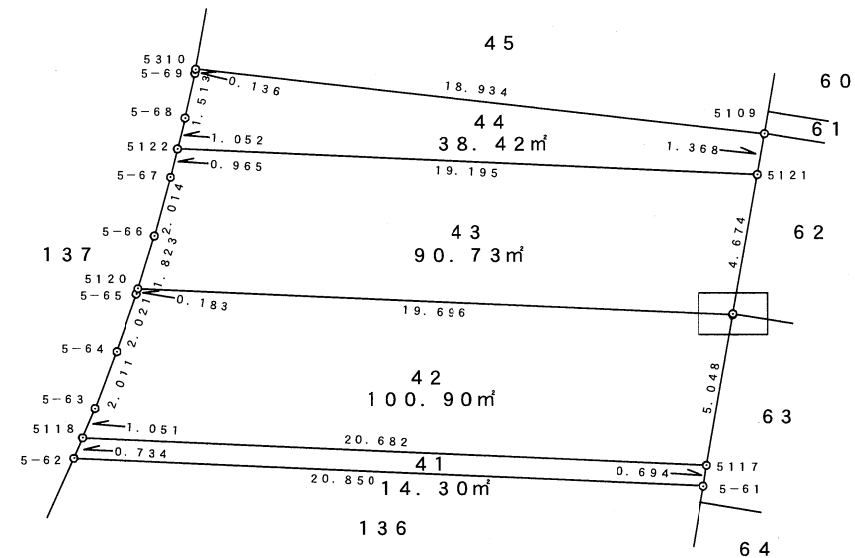

拡大図 1/100